



6th Annual Conference SCCER Mobility

6 September
2019

ETH Zurich
ML Building
Auditorium D 28

Supported by:



Schweizerische Eidgenossenschaft
Confédération suisse
Confederazione Svizzera
Confederaziun svizra

Swiss Confederation

Innosuisse – Swiss Innovation Agency



*Swiss Competence Center for Energy Research
Efficient Technologies and Systems for Mobility*

PROGRAM

- 8.30 Registration & coffee
- 9.15 Introduction & welcome - Konstantinos Boulouchos, Head SCCER Mobility
- 9.20 **KEYNOTE I: International Transport Outlook 2019**
- Elisabeth Windisch, International Transport Forum
- 10.00 **KEYNOTE II: Decarbonization of transport: options and challenges**
- Konstantinos Boulouchos, Head SCCER Mobility
- SESSION I: SCCER Mobility Capacity Area highlights**
- 10.30 **Systems and Components for E-Mobility (Capacity Area A1)**
- Andrea Vezzini, Bern University of Applied Sciences
- 10.50 Coffee break
- 11.20 **Chemical Energy Converters (Capacity Area A2)**
- Christian Bach, Empa
- 11.40 **Minimization of Vehicular Energy Demand (Capacity Area A3)**
- Véronique Michaud, EPFL
- 12.00 Pre-selected poster presentations - 3 min. pitches
- 12.30 **Lunch & poster session I**
- SESSION II: Highlights continued & special topics**
- 13.40 **Design, Demonstration & Dissemination of Systems for Sustainable Mobility (Capacity Area B1)**
- Martin Raubal, ETH Zurich
- 14.00 **Integrated Assessment of Mobility Systems (Capacity Area B2)**
- Stefan Hirschberg, Paul Scherrer Institute
- 14.20 **The evolution of mobility: a socio-economic analysis (Joint Activity CREST-Mobility)**
- René Schumann, University of Applied Sciences Western Switzerland | Thomas Stoiber, University of Basel
- 14.50 **Digitalization Program**
- Annett Laube, Bern University of Applied Sciences | Dejan Milojevic, Empa | Martin Raubal, ETH Zurich | Roman Rudel, University of Applied Sciences and Arts of Italian Switzerland
- 15.20 Coffee break
- 15.40 **PANEL DISCUSSION: Technology and socioeconomic measures promoting decarbonization**
- Elisabeth Windisch, International Transport Forum | Sigrid Pirkelbauer, Federal Roads Office | Christopher Onder, ETH Zurich | Roman Rudel, University of Applied Sciences and Arts of Italian Switzerland
 - Moderator: Andrea Vezzini, Bern University of Applied Sciences
- 16.40 Best Poster Award
- 16.50 Closure & conclusions - Konstantinos Boulouchos, Head SCCER Mobility
- 17.00 **Apéro & poster session II**

SPEAKERS & PANELISTS



Dr. Elisabeth Windisch

Policy Analyst, International Transport Forum, Organisation for Economic Co-operation and Development



Prof. Dr. Konstantinos Boulouchos

Head SCCER Mobility
Aerothermochemistry and Combustion Systems Laboratory, ETH Zurich



Prof. Dr. Andrea Vezzini

Deputy Head & Capacity Area Coordinator A1 SCCER Mobility
Battery & Storage Systems Laboratory, Bern University of Applied Sciences



Christian Bach

Capacity Area Coordinator A2 SCCER Mobility
Automotive Powertrain Technologies, Empa



Prof. Dr. Véronique Michaud

Deputy Capacity Area Coordinator A3 SCCER Mobility
Laboratory for Processing of Advanced Composites, EPFL



Prof. Dr. Martin Raubal

Capacity Area Coordinator B1 SCCER Mobility
Chair of Geoinformation Engineering, ETH Zurich



Dr. Stefan Hirschberg

Capacity Area Coordinator B2 SCCER Mobility
Laboratory for Energy Systems Analysis, Paul Scherrer Institute



Prof. Dr. René Schumann

Joint Activity CREST-Mobility
Applied Intelligent Systems Laboratory, University of Applied Science Western Switzerland



Thomas Stoiber

Joint Activity CREST-Mobility
Sustainability Research, University of Basel



Prof. Dr. Annett Laube

Capacity Area A1 SCCER Mobility
Institute for ICT Based Management, Bern University of Applied Sciences



Dejan Milojevic

Capacity Area A2 SCCER Mobility
Automotive Powertrain Technologies, Empa



Dr. Roman Rudel

Deputy Capacity Area Coordinator B2 SCCER Mobility
Institute for Applied Sustainability to the Built Environment, University of Applied Sciences and Arts of Italian Switzerland



Sigrid Pirkelbauer

Division Head Traffic and Innovation Management, Federal Roads Office



Prof. Dr. Christopher Onder

Capacity Area A2 SCCER Mobility
Institute for Dynamic Systems and Control, ETH Zurich

CONTACT

Management Office SCCER Mobility, ETH Zurich, Leonhardstrasse 27, 8092 Zurich
Pascal Sonder, pascal.sonder@sccer.ethz.ch, +41 44 633 85 86

REGISTRATION | HOTEL

There are no conference fees, but registration is mandatory until 1 September 2019 at the latest. Details are available on our [website](#). For SCCER members hotel reservations will be organized if desired.

CALL FOR POSTERS

All research partners are invited to present their work and projects on a poster A0-size that will be displayed from 8.30 - 17.30.

On the [intranet](#) we provide a PowerPoint template with the SCCER Mobility logo as well as guidelines for poster presenters. We suggest to export the document as a A3-pdf and then print it to A0-size.

Please do not forget to **register and upload your poster until 22 August 2019** on the dedicated [intranet space](#) or send it by e-mail to pascal.sonder@sccer.ethz.ch. Only posters uploaded by that date will be eligible for the "Best Poster Award".

The "Best Poster Award" will be granted during the Annual Conference. The 6 pre-selected poster authors will have the opportunity to present their poster in a 3-minute presentation (poster pitch) during the Annual Conference.

LOCATION | ETH ZURICH

Conference

- ML Building | Auditorium D 28
entrance Clausius-/Tannenstrasse

Poster session, lunch and apéro

- ML Building | Turbinenhalle

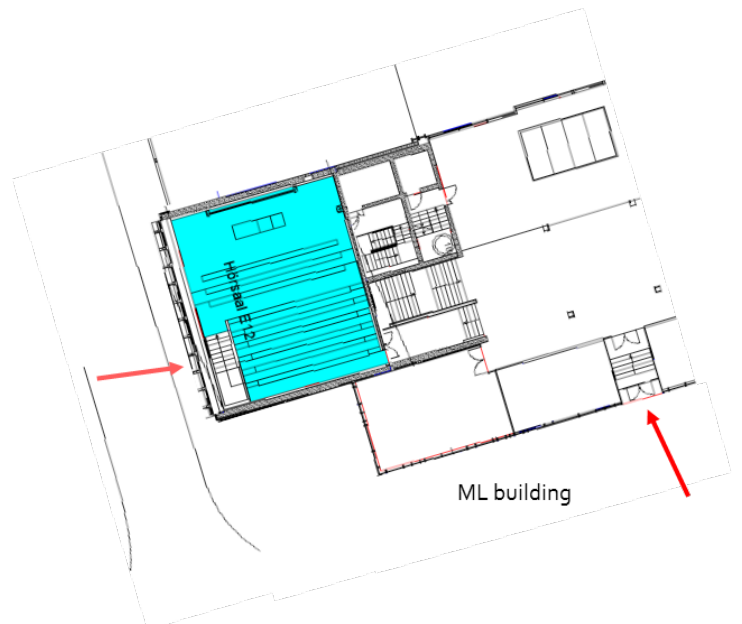

GETTING THERE

By public transportation

- from Bahnhofstrasse/HB stop:
Tram no. 6 (towards Zoo)
- or from Bahnhofplatz/HB stop:
Tram no. 10 (towards Airport or Oerlikon)
to the **ETH/Universitätsspital stop** ●
- or from "Bahnhofstrasse/HB" stop:
Tram no. 3 (towards Klusplatz) to
Central stop (one stop),
from Central by **Polybahn** up to the **Polyterrasse** ●

Journey time: approx. 8 minutes; you will need a ticket that is valid for zone 110 (City of Zurich).

By car

ETH HG parking garage: you will need to purchase a parking ticket from the ticket machine (CHF 2/hour). We cannot guarantee that free parking spaces will be available at any given time.

entrance Karl Schmid-Strasse ● via Leonhardstrasse.

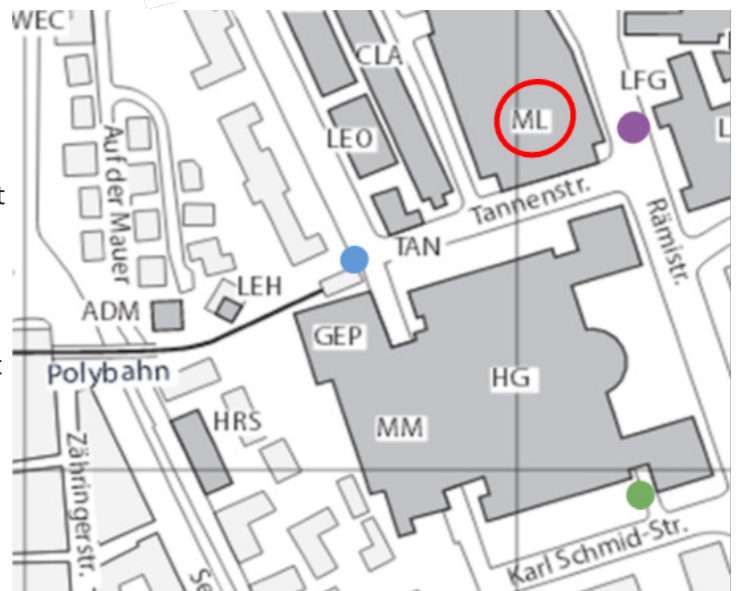

For more details please see the ETH Zurich website.